



ROMANS 12:12  
BE JOYFUL IN HOPE. PATIENT IN AFFLICTION. FAITHFUL IN PRAYER.

**THE BLAZE** was illuminating the predawn sky, and I could feel its heat on my face as I watched the firefighters beat back flames for the second time in three days.

In just over 72 hours, the already complex and challenging situation presented by COVID-19 had grown even more challenging and complex due to two arsonist fires.

Driving home that morning, I experienced a deep sense of peace, a peace the Apostle Paul described as *the peace that passes understanding*. Over the last five months, my experience of this peace has deepened as I've witnessed the Spirit working through the talented, dedicated, and creative members of our Building Committee.

These remarkable women and men listened carefully for God's voice in our congregation's voices through a series of "Discovery and

Dream" conversations in May and June. Working closely together, they translated the hopes and dreams they heard expressed by our congregation into a highly functional design incorporating new construction and the creative repurposing of existing space.

The Building Committee has seized the unique moment the fires have presented us and capitalized upon it in such a creative way that years from now, those of us who have lived through this experience, will say *"that which another intended for evil God intended for good"* (Genesis 50:20).

Since the first century, Christians have seen in the phoenix's fiery death and rebirth from the ashes a symbol of Christ's resurrection. The fires in April were a terrible loss, but that loss pales compared to the opportunity we now have to rise reborn out of the ashes.

## History

**Founded on June 19, 1955**, Broadmoor began with the mission of "extending the work and witness of Christ and his Church in this area." In 2018 Broadmoor rearticulated its mission as "Meeting people where they are and helping them take their next step towards a Christ-centered life."

**On April 1, 2020**, an arsonist fire destroyed the Scout Hut. The arsonist returned on April 3. The second fire obliterated the Administration Building and caused significant damage to the Music Building (original Sanctuary constructed in 1956) and moderate damage to the Sanctuary.

**On April 14**, our Church Council elected the Building Committee. The Building Committee hosted a series of "Design and Dream" meetings to get input from the congregation regarding current congregational needs.

Through the “Design and Dream” meetings, the Building Committee discovered our congregation’s greatest desire is to deepen the sense of community. To achieve this, they repeatedly heard requests to 1) relocate the contemporary worship service to a location closer to the Sanctuary and Children’s Learning Center; and 2) create a larger and more centralized “Connection Café.”

**The proposed building plan achieves these dreams into reality through the creative repurposing of existing space and new construction.**

### **Casual Worship & Music Ministries**

The original Sanctuary, constructed in 1956, will be repurposed as the new home of our contemporary worship service, provide studio space for our growing online ministry and office space for our worship ministries. New construction will provide a multi-purpose space for choir rehearsal and the bride’s room. By relocating the contemporary worship service, our gym will become available for new and creative ministry opportunities on Sunday mornings.

### **Café-Welcome Center**

New construction will provide a generous central gathering space for our congregation before and after worship services and offer an inviting space for receptions during the week. This space will also feature a caterer’s kitchen, restrooms, and a receptionist area.

### **Children’s Education Building**

The Children’s Building will receive a new covered entrance to better welcome families to both weekday children’s ministries and Sunday School. The playgrounds will be receiving new equipment and desperately needed drainage improvements.

### **Sanctuary Plaza & Covered Walk to Adult Education Building**

The green space in front of the Sanctuary will become a central plaza featuring new widened walkways. A new covered walkway will connect the Adult Education Building to the Café-Welcome Center.

### **Columbarium & Sanctuary Courtyard**

A new columbarium adjacent to the Sanctuary’s east transept will provide a beautiful place to remember loved ones. A redesigned courtyard will feature a custom baptismal water feature.

### **Scout Hut**

A new Scout Hut, designed by a former Troop 478 Eagle Scout, will be constructed on the site of the former building.



## *Next Steps*

Total project costs are estimated to be \$3.5 million To date, we have received just over \$500,000 in insurance payments These funds, along with any future settlement proceeds, will be applied to this project.

While tragic, the fires present a unique opportunity for our congregation to update and modernize our campus.

There is no better way for us to honor the Spirit that has guided Broadmoor during its first sixty-five years than seizing this moment and creating space to help us fulfill our mission of meeting people where they are and helping them take their next step towards a Christ-centered life.

NEW BUILDING  
3-D ARIAL  
RENDERING WITH  
CAMPUS &  
WALKWAYS

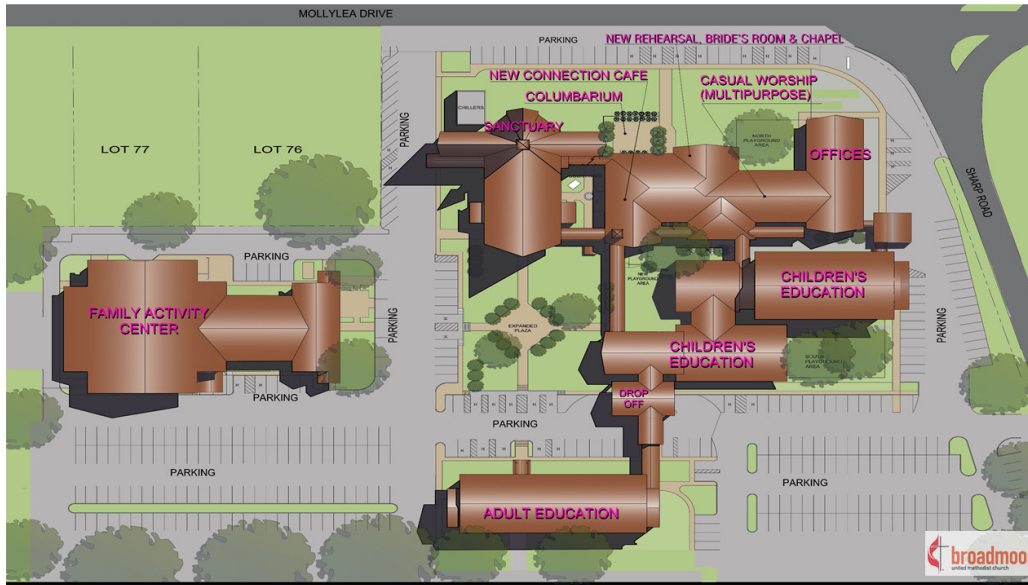

NEW CAMPUS  
EXTERIOR  
OVERHEAD  
RENDERING

NEW CAMPUS  
INTERIOR  
OVERHEAD  
RENDERING

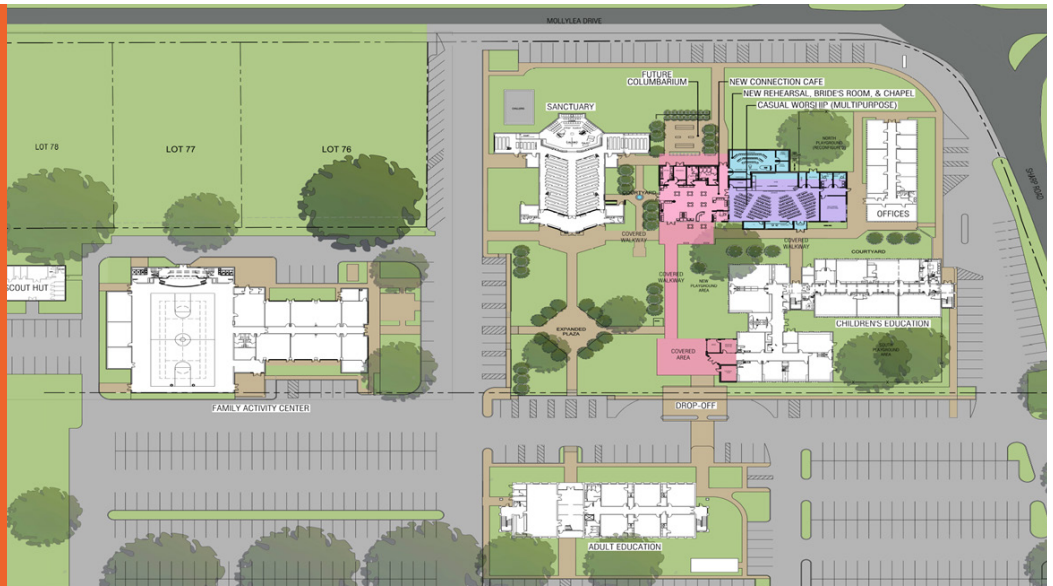

SANCTUARY & NEW BUILDING INTERIOR OVERHEAD RENDERING



NEW SCOUT HUT 3-D EXTERIOR RENDERING

NEW SCOUT HUT INTERIOR OVERHEAD RENDERING

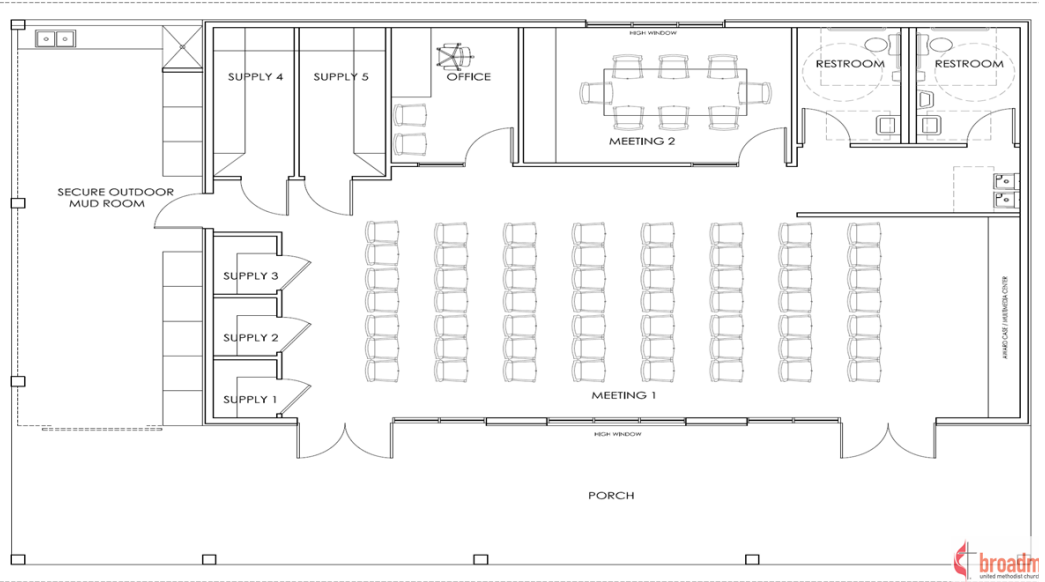

NEW BUILDING  
3-D CAMPUS  
GROUND LEVEL  
RENDERING

